

BIN

Designer: SPARK

**MATERIALS**

- Zinc plated mild steel
- 316 stainless steel

FINISHES

- Powdercoated body
- #4 Stainless brushed body
- #4 Stainless brushed chute

SIZES

- 120 / 140 Litre
- 240 Litre

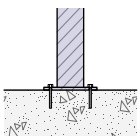
INSTALLATION

Bolt Down

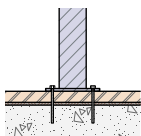

Bolt Through

FIXINGS

- 12mm fixings for 14mm diameter holes

Alternative materials and finishes available on request

PARADE BIN 120/140 L

SPECIFICATIONS

Dimensioned Line Drawing coming soon

Measurements are in millimetres. Drawings are not to scale.

PRODUCT CODE	BODY & FINISH	CHUTE & FINISH	SIZE
PDE001-ZIN-PC-S-120L	Mild steel, Powdercoated	316 Stainless steel, #4 Brushed	120/140L
PDE001-S16-N4-S-120L	316 Stainless steel, #4 Brushed	316 Stainless steel, #4 Brushed	120/140L

PARADE BIN 240 L

SPECIFICATIONS

Dimensioned Line Drawing coming soon

Measurements are in millimetres. Drawings are not to scale.

PRODUCT CODE	BODY & FINISH	CHUTE & FINISH	SIZE
STD001-ZIN-PC-S-240L-RS	Mild steel, Powdercoated	316 Stainless steel, #4 Brushed	240L
STD001-S16-N4-S-240L-RS	316 Stainless steel, #4 Brushed	316 Stainless steel, #4 Brushed	240L